



UNDER GROUND DUST BIN (SMART BIN)
UGD- UGD-01, UGD-02, UGD-03,04,05
(1100 Liter)



Flexible modular system

A UTC Industries system is the best solution for tight spaces. In old towns where the emptying vehicles have no opportunities to drive in, are our hydraulic systems the only opportunity to provide cleanliness.

The existing infrastructure is gently lowered from the surface into the underground. Conventional collection containers are placed on a hydraulically driven auto hoist and can be emptied with a conventional emptying vehicle.

<http://www.utcindustry.com/>

UTC INDUSTRIES
Greater Noida (INDIA)

The four components of a UTC system

- | | |
|---------------------|---|
| 1. Concrete Element | Prefabricated and waterproof concrete element |
| 2. Lift | Lift construction with an upper walkway and lower bearing platform |
| 3. Throw-in column | The throw-in column is centrally assembled on the platform and above the bin |
| 4. Power Unit | Electro-hydraulic power system placed in the secondary shaft or compactor vehicle |

Lift Position in the underground

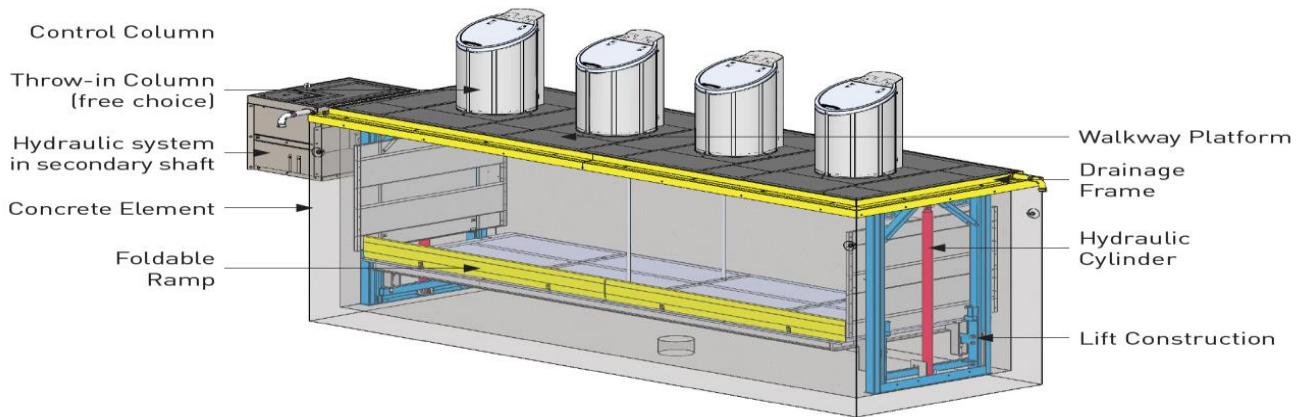

Extended Lift Position

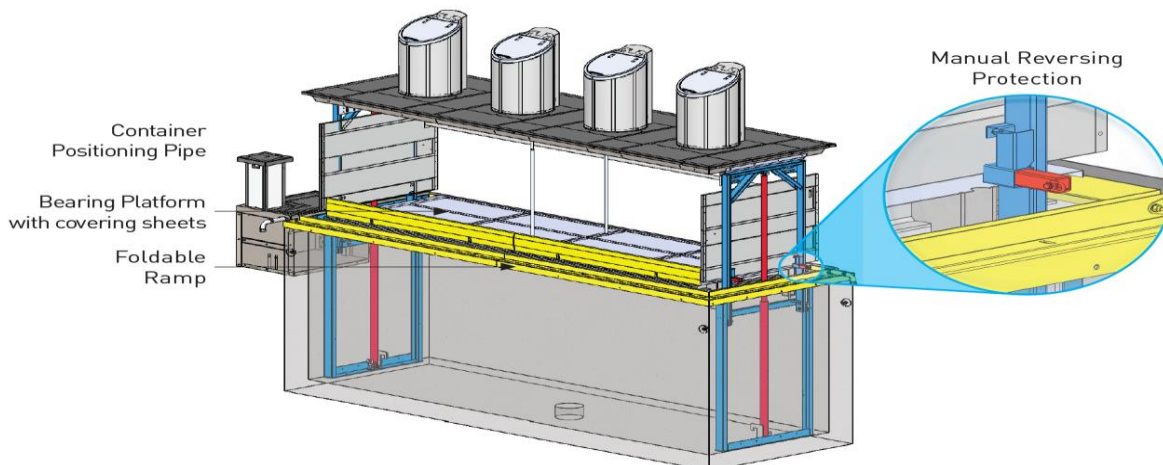

Products

1. UGD-01 (Collection Container- 1 Container 1100 liter)
2. UGD-02 (Collection Container- 2 Container 1100 liter)
3. UGD-03 (Collection Container- 3 Container 1100 liter)
4. UGD-04 (Collection Container- 4 Container 1100 liter)
5. UGD-05 (Collection Container- 5 Container 1100 liter)

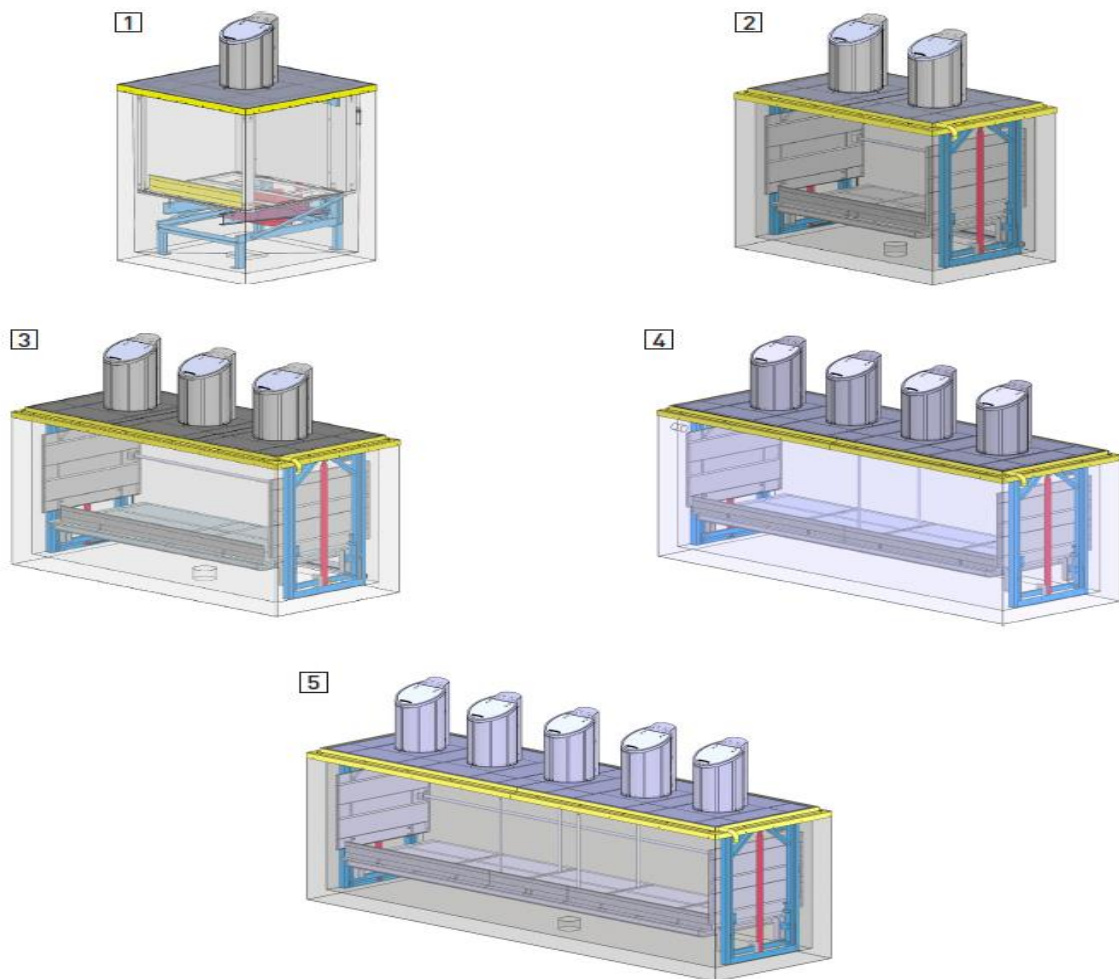

Operation and Hydraulic

To lift the lift system out of the concrete element, it will be controlled, depends on the product through a control bulb or an operation panel.

UGD-01

The hydraulic aggregate is located directly in the concrete element. If the the throw-in column includes a power supply, the control bulb is placed in the back of the throw-in column.

If the lift is operating through an external hydraulic system, for example through the system of the garbage truck, the hydraulic connection is also placed in the back of the throw-in column.

UGD-02, 03, 04, 05

The hydraulic aggregate of the series UGD-02, 03 etc. are placed in a separate secondary shaft beside the lift system. The aggregate and the lift system are connected on the lift cylinders through hydraulic pipes

To operate the lift system is a control bulb which is lowered in the secondary shaft or a fixed control column (with keylock) available.

If the lift is operating through an external hydraulic system, for example through the system of the garbage truck, the hydraulic connection is also placed in the back of the throw-in column.

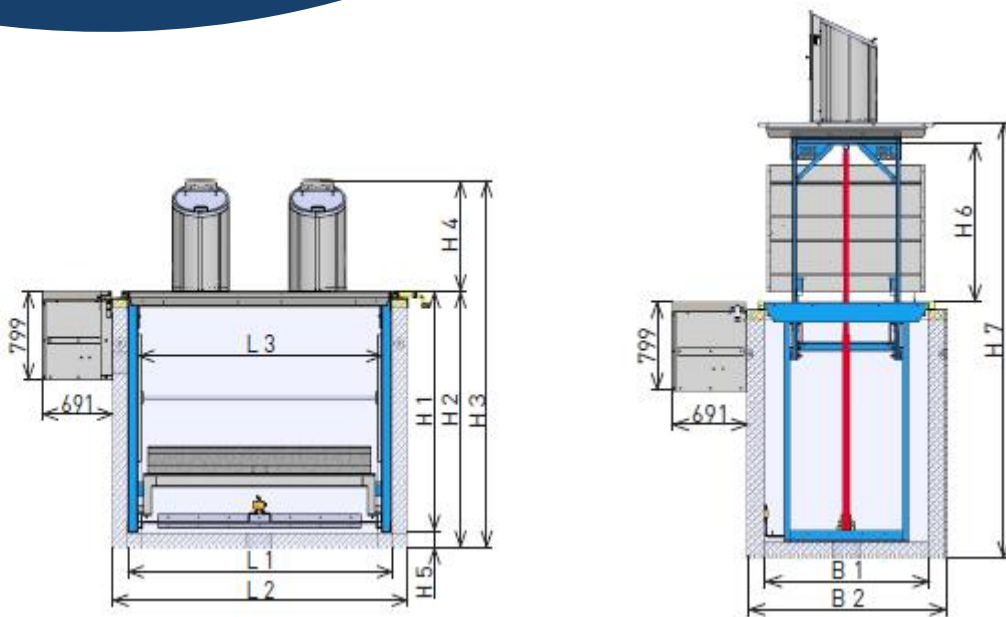

Meas.(mm)	L1	L2	L3	H1	H2	H3	H4	H5	H6	H7	B1	B2
UGD-02	2600	2900	2330	2159	2309	3304	995	150	1489	3798	1500	1800
UGD-03	3600	3900	3330	2159	2309	3304	995	150	1489	3798	1500	1800
UGD-04	5000	5300	4730	2159	2309	3304	995	150	1489	3798	1500	1800
UGD-05	6050	6350	5770	2159	2309	3304	995	150	1489	3798	1500	1800

ULTRASONIC FILL LEVEL SENSOR

NETWORK SOFTWARE

Our sensor is a wireless ultrasonic fill-level sensor that securely monitors a container's fill-level and sends real-time data to Networks, our cloud-based monitoring and data analytics platform. This sensor can be easily attached to any type of container or tank to monitor any type of waste, including solids and liquids. Together with the cloud platform,

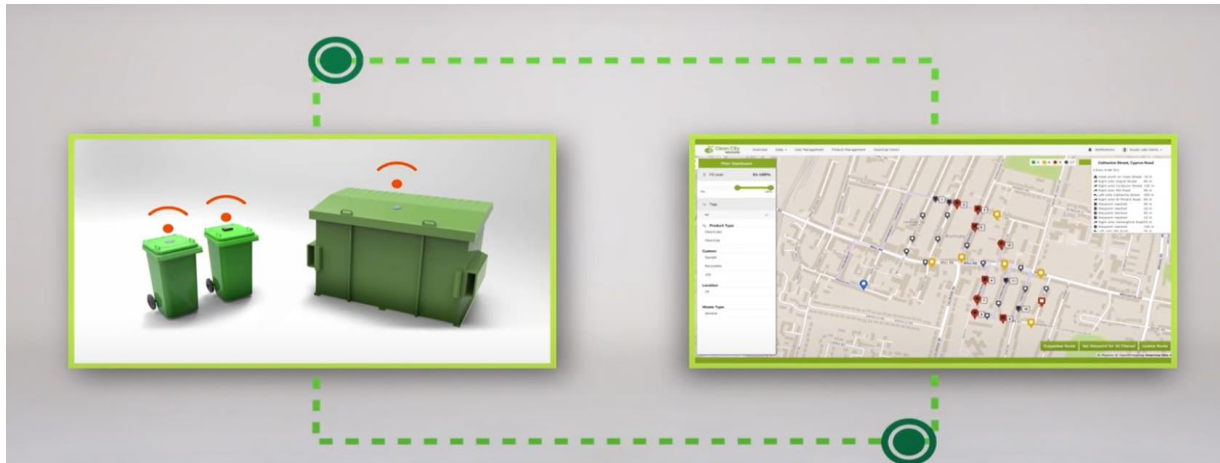

Networks software is our waste management platform and the glue that binds all our solutions together. software provides the monitoring environment, smart dashboard, analytics, and control center in one comprehensive and simple package. Web-based and cloud-hosted, software is available anywhere you have a modern browser and an internet connection. It gives you total control and insight into your waste management operations and has proven cost-reduction benefits in all sectors of your operation.



[WATCH VIDEO](#)

<http://www.utcindustry.com/>

UTC INDUSTRIES
Greater Noida (INDIA)